

MapeShieldTM

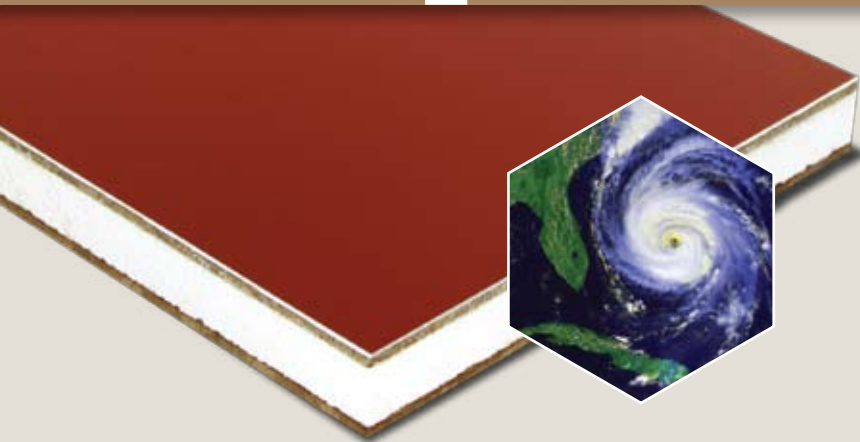

IMPACT AND BLAST RESISTANT PANELS

FEATURES

- Hurricane Resistant (Large and Small Missile)
- Blast Resistant
- High Thermal Values—R up to 27.9
- Available In Any Architectural Finish



Mapes Industries has developed an impact resistant line of laminated panels for use in curtain wall, storefront and window applications where design elements require high impact / high load materials. MapeShield panels can be used in any framing system design for this type of application. The panels can match any architectural finish including Porcelain, Kynar, Anodized and Baked Enamel. Custom applications including bullet resistant and Class 1 blast resistant panels are also available.

MapeShield panels are designed for use as a replacement for any glazed area. The panels have passed both ASTM-E-1886-97 missile impact and pressure cycling and ASTM-E-1996-02 windborne debris in hurricanes.

For design and budget information, please visit www.mapes.com/mapeshield.

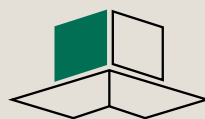

mapes
ARCHITECTURAL PANELS

Mapes Panels, LLC
2929 Cornhusker Hwy / Lincoln, NE 68504
800-228-2391 / 800-737-6756 fax
sales@mapes.com / www.mapespanels.com

APPLICATIONS

- Glazing Infill
- Curtain Wall
- Soffit
- Wall Facing
- Accent Panels

CORE OPTIONS

- 2.0 lb. density polystyrene - Extra high density polystyrene for additional rigidity and flatness.
- Polyisocyanurate - improved insulation values.
- Mineral Fiber Board - Class A fire rated.

TYPICAL CROSS SECTION

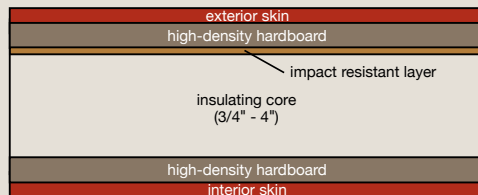

SELECTION GUIDE

| SKINS | THICKNESS | TEXTURE | | STANDARD COLORS | CUSTOM COLORS | AVAILABLE WIDTHS | | FINISH WARRANTY |
|-----------------------------|--|----------|--------|------------------------|---------------|------------------|-----|----------------------------|
| | | EMBOSSED | SMOOTH | | | 48" | 60" | |
| Porcelain on Aluminum | 0.016 | • | | 24 | • | • | • | 25 |
| Porcelain on Steel | 0.014 | | • | 8 | • | • | • | 20 |
| Standard .032 Kynar | 0.032 | • | • | 18 | | | • | 20 |
| Custom Kynar | 0.036 - 0.125 | • | • | | • | • | • | 10 |
| Spandrel Glass | 0.25 | | • | 8 | • | • | • | 5 |
| Colorlume E | 0.012 | • | | 6 | | | • | 5 |
| Colorlume S | 0.022 | | • | 2 | | | • | 5 |
| .025 Clear Anodized (Coil) | 0.025 | | • | 1 | | | • | N/A |
| .025 Bronze Anodized (Coil) | 0.025 | | • | 1 | | | • | N/A |
| Class 1 Anodized | 0.036 - 0.125 | • | • | | • | • | • | |
| | | | | | | | | LAMINATION WARRANTY |
| SUBSTRATES | | | | | | | | |
| 1/8" Hardboard | 0.125 | | | MOST ECONOMICAL | | • | • | 25 |
| 3/16" Hardboard | 0.187 | | | MOST ECONOMICAL | | • | • | 25 |
| 1/2" Gypsum | 0.5 | | | FIRE RESISTANT | | • | | 25 |
| Cement Board | 4mm | | | WATER/IMPACT RESISTANT | | • | | 25 |
| Corelite (H.D.P.E.) | 4mm | | | WATER RESISTANT | | • | • | 5 |
| CORES | | | | | | | | |
| 2# Density Polystyrene | most cost effective per R-Value (4.74 - 20.31 R-Value) | | | | | | | |
| Isocyanurate | most insulation per inch (6.41 - 27.79 R-Value) | | | | | | | |
| Micore | Class A Fire Rated (3.05 - 15.50 R-Value) | | | | | | | |